

DESIGNER COLLECTION

DOMINGO

6636

SIZE

66" L x 36"W x 24"D

WATER CAPACITY

75 Gallons

WEIGHT

160 Pounds

INSTALLATION

Freestanding

BACK SLOPE

18°

MATERIAL

Acrylic

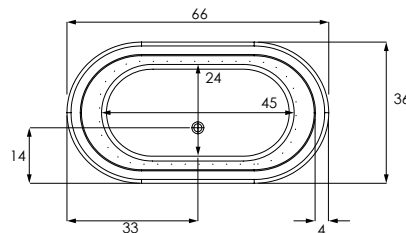
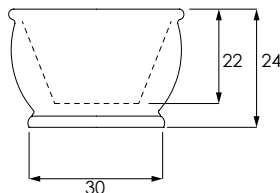
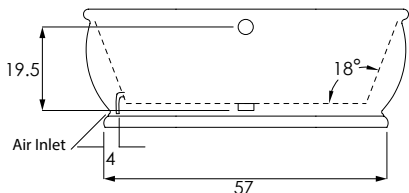

MODEL

MDO6636ATO Tub Only

MDO6636ATA Thermal Air

COLORS

Standard Acrylic	White Biscuit Bone
Premium Acrylic	Black Sterling Silver Carmine Red Concrete Grey Distant Blue Grey Beige Moss Green Orange
Premium Hydroluxe Colors	Brown Pastel Violet Purple Violet Red Orange Sapphire Blue Signal Orange Stone Grey Tarpaulin Grey Terra Brown

FINISH

Matte Finish MAT (must specify if desired)

Polished Finish STANDARD

DUAL COLOR OPTION

MODEL/COLOR1 INT/COLOR2 EXT (XXX.XXX.XXX)

SURFACES (outside only)

Metallic: Polished Nickel [PN]

MODEL/METAL/COLOR (XXX.XXX.XXX)

MODEL

COLD PLUNGE | [order form](#) CLD.PL

EXPORT CRATE FRT.EXPCRT

EXTRA HIGH DENSITY HI.DEN

GRAB BARS (Pair) Refer to price book for all available finishes

Standard Grab Bars GRA.BAR-XXX

Universal Grab Bars UGB.BAR-XXX

HEATED BACKREST INCLUDED ON THERMAL AIR

HYDRO BLANKET BLA.HEA-X
2 Zones | 3 Zones | 4 Zones (3 or 4 zones require two keypads)

HYDRO COAT HYC.COA

HYDRO EXPRESS 69.104-HYD.EXP-FRE

HYDRO FUSION | [order form](#)

Hydro Fusion (Tub Only)	29.102
Hydro Fusion w/ Ozone (Tub Only)	29.103
Hydro Fusion (TA, Whirlpool, Combo)	29.107

HYDRO INDULGE | [order form](#) HYD.IND

HYDRO OZONE INCLUDED ON THERMAL AIR



HYDRO SYSTEMS



Headquarters
29132 Avenue Paine
Valencia, CA 91355

Manufacturing Facility
385 Highway 155 South
McDonough, GA 30253

Technical Support
support@hydrosystem.com

Orders Department
orders@hydrosystem.com

General Information
info@hydrosystem.com

Phone: 661-775-0686

Website: hydrosystem.com

CODES AND COMPLIANCES

Massachusetts code File no: P1-0614-491



All specifications and options subject to change without notice please contact a hydro systems representative for more information.

DOMINGO

6636

DESCRIPTION	
LED TEMP. READOUT KEYPAD Upgrade only, must have a keypad controlled system to purchase.	LED.UPG
LIGHTING LED Bath Light Chromotherapy System	LIG.LED

DESCRIPTION	
REMOTE CONTROL Must must have system to purchase	REM.CON
TOWER Must specify size & location on tub. Can hide plumbing, fusion, or indulge.	TOW-XX
18" or 24"	25" - 30"
31" - 36"	37" - 42"
43" - 48"	49" - 54"
55" - 60"	Access Panel
INTEGRAL W/O (Std. round) Waste and overflow manufactured as part of the bath. Comes standard as a round overflow cover. Drain will be a tip-toe style and drain outlet will be a direct drain. (WHI, BIS, PC, PB, PN, BC, BB, BN, SC, SB, SN, ORB, PE, MB)	IWO.XX (INCLUDED)
W/O - Gold Finish Upgrade (PG, BG)	
LINEAR INTEGRAL W/O Waste and overflow manufactured as part of the bath. Drain will be a tip-toe style and drain outlet will be a direct drain.	LWO-XXX (NO CHARGE UPGRADE)



Headquarters
29132 Avenue Paine
Valencia, CA 91355

Manufacturing Facility
385 Highway 155 South
McDonough, GA 30253

Technical Support
support@hydrosystem.com

Orders Department
orders@hydrosystem.com

General Information
info@hydrosystem.com

Phone: 661-775-0686
Website: hydrosystem.com

CODES AND COMPLIANCES

Massachusetts code File no: P1-0614-491



All specifications and options subject to change without notice please contact a hydro systems representative for more information.

DOMINGO

6636



STANDARD ACRYLIC COLORS **PREMIUM ACRYLIC COLORS**



PREMIUM HYDROLUXE COLORS



WELLNESS OPTIONS

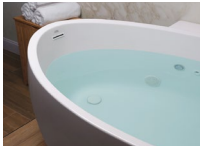

Cold Plunge
Revitalizing cold hydrotherapy into a traditional tub



Thermal Air
Tiny bubbles into the bathwater and offers untold relaxing benefits, similar to Swedish massage



Hydro Indulge
A concentrated dose of oxygen-rich molecules cleanse and restore skin



Advanced UV system
Ozone and UV light helps to disinfect the water and keep it clean



Chromatherapy
Digitally controlled, multicolored lighting feature LED lighting system



Hydro Fusion
Totally silent operation maintains ideal temperature without adding hot water constantly



Hydro Blanket
Radiant heat emanates through the acrylic tub surface. Chose up to 2-4 panels.

OTHER OPTIONS

Additional options can be found on our website



Integral Waste and Overflow
Seamless built-in protection for bathtub (included)



Grab Bars
Adds functionality and enhanced styling. Affords a mounting solution in virtually any position on any tub.



Tower
Ideal solution adding systems or roman tub faucet to a freestanding bathtub.



Island Tub Drain
Asymmetrical 18 Gauge Epoxy coated Metal Deck Flange makes installation in tight spaces easier.

Installation Tips:

• When adding Thermal Air, blower must be remotely located



Headquarters
29132 Avenue Paine
Valencia, CA 91355

Manufacturing Facility
385 Highway 155 South
McDonough, GA 30253

Technical Support
support@hydrosystem.com

Orders Department
orders@hydrosystem.com

General Information
info@hydrosystem.com

Phone: 661-775-0686
Website: hydrosystem.com

CODES AND COMPLIANCES

Massachusetts code File no: P1-0614-491



All specifications and options subject to change without notice please contact a hydro systems representative for more information.