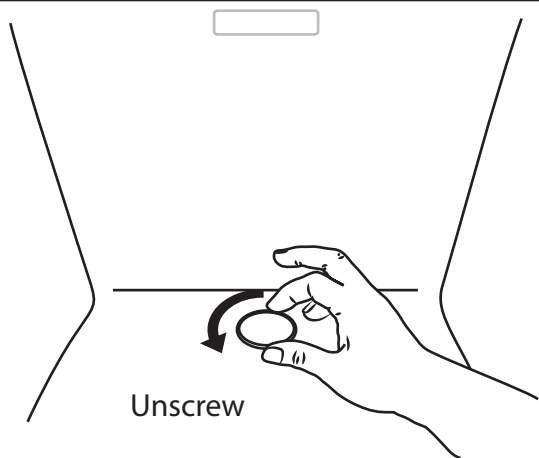
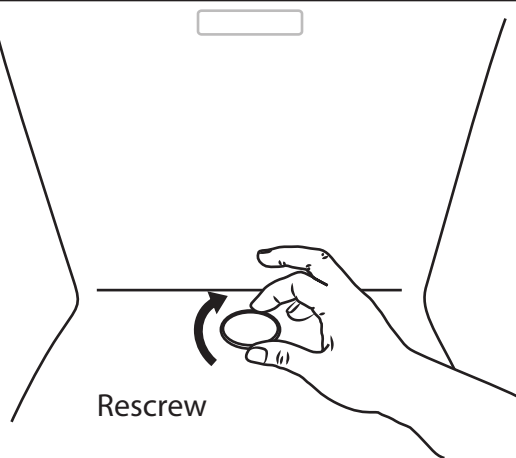
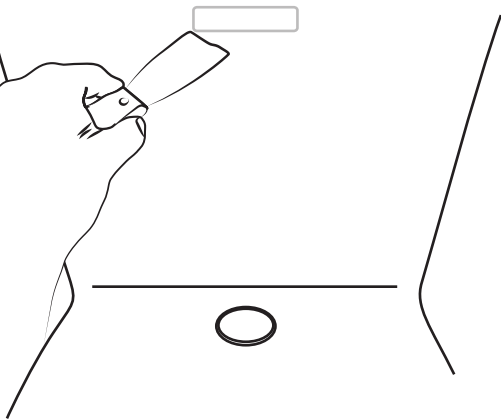
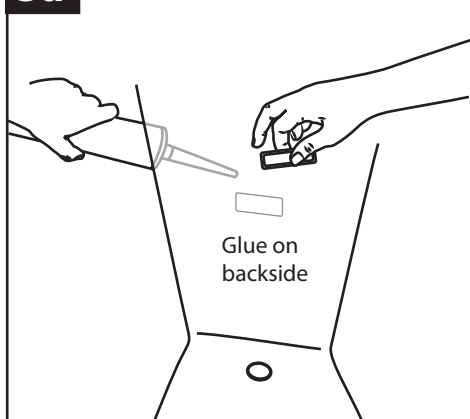

## INSTRUCTIONS FOR CHANGING LINEAR WASTE AND OVERFLOW FINISH

1. Unscrew drain at bottom of tub and replace by screwing in new drain until tight.
2. Remove linear overflow by using a plastic tool to pop off. We recommend using a plastic putty knife. Be careful not scrape the tub acrylic. Overflow finish should pop-off with little resistance.
3. Once removed apply silicone or other adhesive to back of new linear overflow and place on to bathtub in proper location. Follow adhesive instructions for proper setting.

**1****1b****2****3a****3b**