

GRANT

6636

SIZE

66.36.23 (Includes Faucet Deck)

WATER CAPACITY

70 Gallons

WEIGHT

450 Pounds

INSTALLATION

Freestanding

BACK SLOPE

29°

MATERIAL

HydroLuxe SS™

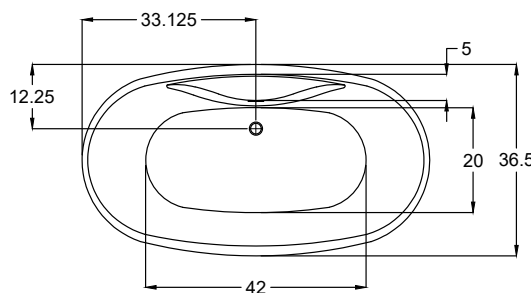
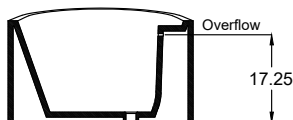
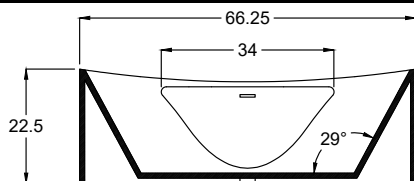
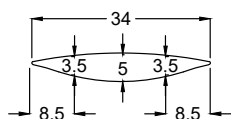
**Faucet Deck**

| MODEL | DESCRIPTION |
|--------------------------------------|---|
| GRT6636HTO | Tub Only |
| GRT6636HTA | Thermal Air |
| HYDROLUXE SS™ COLORS | |
| Standard | Almond White Biscuit |
| Premium Colors | Black Carmine Red Concrete Grey Distant Blue Grey Beige Moss Green Orange Brown Pastel Violet Purple Violet Red Orange Sapphire Blue Signal Orange Stone Grey Tarpaulin Grey Terra Brown |
| DUAL COLOR OPTION | |
| DUAL.COL.XXX-XXX | |
| Group 1 - White with any color added | |
| Group 2 - two different colors | |
| FINISH | |
| Matte Finish | METRO.MAT |
| Polished Finish | METRO.POL |
| Matte Gloss Combination | METRO.TWOTONE |
| SURFACES (OUTSIDE ONLY) | |
| Metallic: Polished Nickel (PN) | |

| MODEL | DESCRIPTION |
|--|---|
| ACCESS PANEL | GRT-ACC.PNL |
| COLD PLUNGE order form | CLD.PL |
| FAUCET HOLES | GRT-FCT.DRL |
| HYDRO FUSION order form | 29.107 |
| HYDRO INDULGE order form | HYD.IND |
| HYDRO OZONE | |
| ISLAND TUB DRAIN | ITD.XXX |
| | ABS, PVC ITD.ABS ITD.PVC CAST IRON ITD.CST |
| WASTE & OVERFLOW | Linear Integral W/O LWO-XXX WHI, BIS, PC, PB, PN, BC, BB, BN, SC, SB, SN, ORB, PE, MB Gold Finish Upgrade (PG, BG) |
| EXPORT CRATE | FRT.EXPCRT |



HYDRO SYSTEMS

**Headquarters**29132 Avenue Paine
Valencia, CA 91355**Technical Support**support@hydrosystem.com**Orders Department**orders@hydrosystem.com**General Information**info@hydrosystem.com

Phone: 661-775-0686

Website: hydrosystem.com**CODES AND COMPLIANCES**

Massachusetts code File no: P1-0614-491



ADA Compliant

All specifications and options subject to change without notice
please contact a hydro systems representative for more information.

GRANT

6636



STANDARD COLORS



WHITE BISCUIT ALMOND

PREMIUM COLORS



BLACK GREY BEIGE STONE GREY MOSS GREEN ORANGE BROWN PASTEL VIOLET PURPLE VIOLET RED ORANGE STONE GREY TARPAULIN GREY TERRA BROWN CARMINE RED CONCRETE GREY DISTANT BLUE SIGNAL ORANGE SAPPHIRE BLUE

CUSTOM COLOR

Hydro Systems can match virtually any color including RAL and Pantone



PANTONE®

WELLNESS OPTIONS

**Cold Plunge**

Revitalizing cold hydrotherapy into a traditional tub

**Thermal Air**

Tiny bubbles into the bathwater and offers untold relaxing benefits, similar to Swedish massage

**Hydro Indulge**

A concentrated dose of oxygen-rich molecules cleanse and restore skin

**Advanced UV system**

Ozone and UV light helps to disinfect the water and keep it clean

**Hydro Fusion**

Totally silent operation maintains ideal temperature without adding hot water constantly

**Tower**

Ideal solution adding systems or roman tub faucet to a freestanding bathtub.

OTHER OPTIONS

Additional options can be found on our website

**Integral Waste and Overflow**

Seamless built-in protection for bathtub (included)

**Island Tub Drain**

Asymmetrical 18 Gauge Epoxy coated Metal Deck Flange makes installation in tight spaces easier.

ELECTRICAL REQUIREMENTS

All electrical information can be found on our website

INSTALLATION VIDEOS

All installation videos can be found on our website

Installation Tips:

- When adding Thermal Air, blower must be remotely located



HYDRO SYSTEMS



Headquarters

29132 Avenue Paine
Valencia, CA 91355

Manufacturing Facility

385 Highway 155 South
McDonough, GA 30253

Technical Support

support@hydrosystem.com

Orders Department

orders@hydrosystem.com

General Information

info@hydrosystem.com

Phone: 661-775-0686

Website: hydrosystem.com

CODES AND COMPLIANCES

Massachusetts code File no: P1-0614-491



All specifications and options subject to change without notice please contact a hydro systems representative for more information.